

TG-401

(11W) $\phi 46.5$, 5-SLOT AND LONG LIFE.

APPLICATION PRINTER / PLOTTER / HOPPER / CUTTER / GAMING MACHINE / VENDING MACHINE / BANKING MACHINE etc.

BE

TG-401A

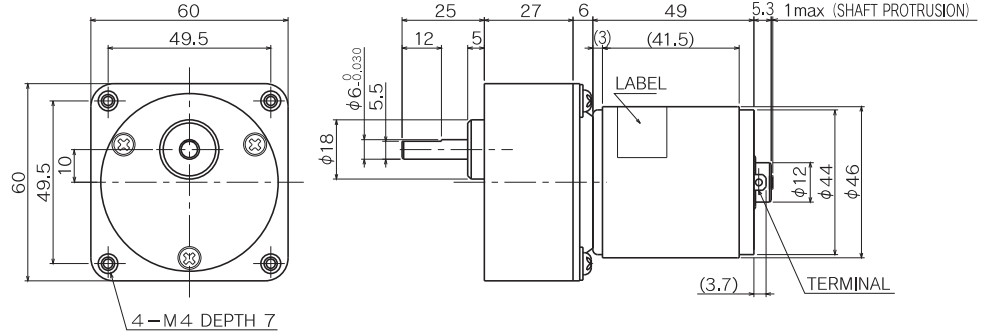

Allowable torque-speed characteristics

BE

MODEL	GEAR RATIO	1	1	1	1	1	1	1	1	1	1	1	1	1	1	1	
		5	10	12.5	15	18	25	30	50	75	100	150	200	300	500	750	1000
TG-401A-BE (24V)	SPEED (r/min)	803	396	317	268	224	164	132	79.3	54.8	42.8	29.7	22.7	15.3	9.3	6.3	4.7
	TORQUE (mN·m)	98	196	245	245	294	441	539	882	980	980	980	980	980	980	980	980
	TORQUE (kgf·cm)	1	2	2.5	2.5	3	4.5	5.5	9	10	10	10	10	10	10	10	10

BE

GEAR RATIO	STAGE	TORQUE		WEIGHT (g)
		(mN·m)	(kgf·cm)	
1/3 ~ 1/12.5	2	980	10	255
1/15 ~ 1/60	3	980	10	270
1/75 ~ 1/250	4	980	10	285
1/300 ~ 1/1000	5	980	10	300

BM

TG-401A

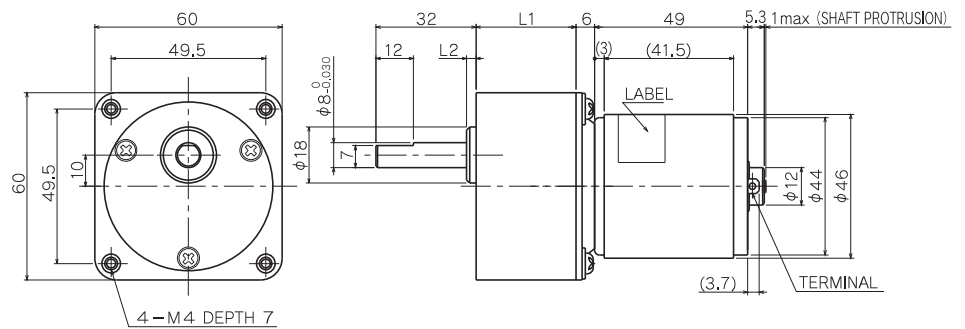

Allowable torque-speed characteristics

BM

MODEL	GEAR RATIO	1	1	1	1	1	1	1	1	1	1	1	
		5	10	12.5	18	25	30	50	75	100	120	150	180
TG-401A-BM (24V)	SPEED (r/min)	793	396	317	224	159	132	79.3	53	39.2	32.8	26.3	24.1
	TORQUE (mN·m)	98	196	245	294	441	539	882	1176	1666	1960	2450	2450
	TORQUE (kgf·cm)	1	2	2.5	3	4.5	5.5	9	12	17	20	25	25

BM

GEAR RATIO	L1 (mm)	L2 (mm)	STAGE	TORQUE		WEIGHT (g)
				(mN·m)	(kgf·cm)	
1/3 ~ 1/15	32	3	2	1470	15	310
1/18 ~ 1/60	42	5	3	2450	25	400
1/75 ~ 1/180	42	5	4	2450	25	430