

# TG-21

(13 ~ 17W)  $\phi 46.5$ , 5-SLOT,  
HIGHLY-RELIABLE AND HIGH-TORQUE.

## APPLICATION

BUS DESTINATION INDICATOR / STIRRING MECHANISM / SECURITY CAMERA / MONEY COUNTING MACHINE /  
DENTAL MACHINE / BILL SORTER / CUTTER etc.

## BE

TG-21Q  
TG-21R

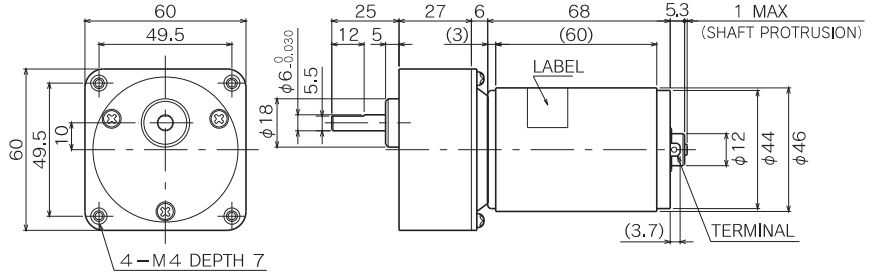

## Allowable torque-speed characteristics

BE

MODEL	GEAR RATIO	1	1	1	1	1	1	1	1	1	1	1	1	1	1	1	
		5	10	12.5	15	18	25	30	50	75	100	150	200	300	500	750	1000
TG-21Q-BE (24V)	SPEED (r/min)	874	434	341	287	240	178	142	86	58.7	44.8	30.4	23	15.3	9.2	6.2	4.6
	TORQUE (mN·m)	107.8	196	294	294	343	490	637	980	980	980	980	980	980	980	980	980
TG-21R-BE (12V)	SPEED (r/min)	1135	564	444	372	311	232	185	112	76.4	58.3	39.5	29.9	19.9	12	8	6
	TORQUE (mN·m)	107.8	196	294	294	343	490	637	980	980	980	980	980	980	980	980	980
	TORQUE (kgf·cm)	1.1	2	3	3	3.5	5	6.5	10	10	10	10	10	10	10	10	10

BE

GEAR RATIO	STAGE	TORQUE		WEIGHT (g)
		(mN·m)	(kgf·cm)	
1/3 ~ 1/12.5	2	980	10	255
1/15 ~ 1/60	3	980	10	270
1/75 ~ 1/250	4	980	10	285
1/300 ~ 1/1000	5	980	10	300

## BM

TG-21Q  
TG-21R

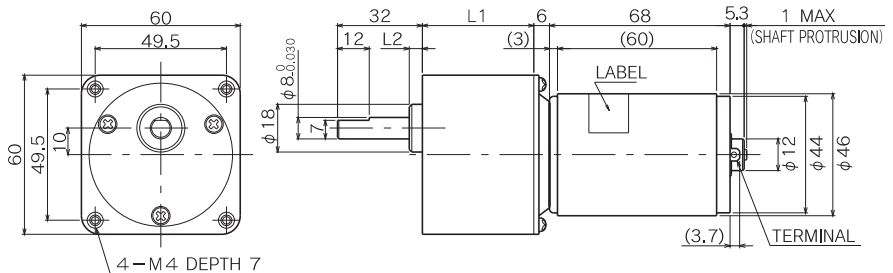

## Allowable torque-speed characteristics

BM

MODEL	GEAR RATIO	1	1	1	1	1	1	1	1	1	1	1	1
		5	10	12.5	18	25	30	50	75	100	120	150	180
TG-21Q-BM (24V)	SPEED (r/min)	854	434	341	240	172	142	86	57.1	42.8	35.6	28.9	26.1
	TORQUE (mN·m)	117.6	196	294	343	490	637	980	1372	1862	2254	2450	2450
TG-21R-BM (12V)	SPEED (r/min)	1109	564	444	311	223	185	112	74.2	55.6	46.3	37.5	33.9
	TORQUE (mN·m)	117.6	196	294	343	490	637	980	1372	1862	2254	2450	2450
	TORQUE (kgf·cm)	1.2	2	3	3.5	5	6.5	10	14	19	23	25	25

BM

GEAR RATIO	L1 (mm)	L2 (mm)	STAGE	TORQUE		WEIGHT (g)
				(mN·m)	(kgf·cm)	
1/3 ~ 1/15	32	3	2	1470	15	310
1/18 ~ 1/60	42	5	3	2450	25	400
1/75 ~ 1/180	42	5	4	2450	25	430